

Atexco

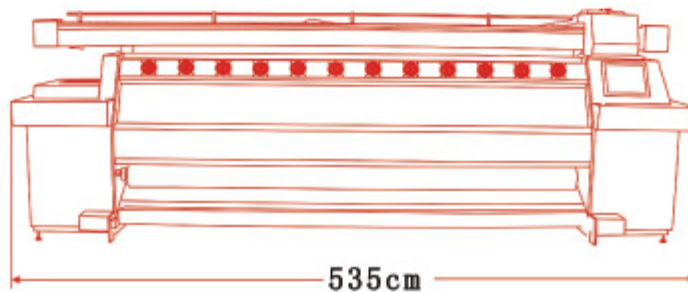

正视图

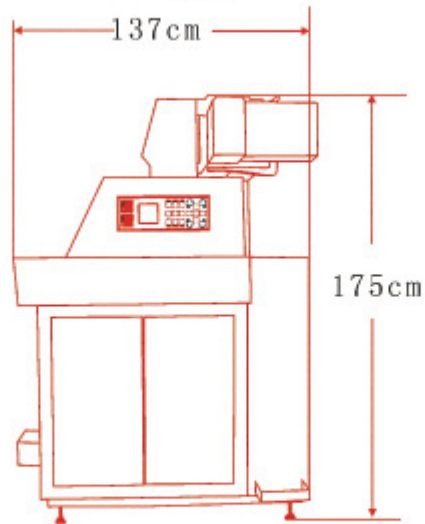

8320TX Roll to Roll Direct to Fabric Printer

Primary Specification

Product Model		Aprint 8320TX	
Printing Head	Model	Spectra SL- 128/ SM-128, on-demand piezo head	
	Number of Heads	24	
	Ink Drop Size	80 pl (SL-128) or 50pl (SM-128)	
	Height	3mm – 5cm above media, adjustable	
	Voltage Adjustment	Voltage adjustable for each print head	
Number of Color		6-color (3 heads / 128 nuzzles per color)	
Print Mode	360X 400 DPI	74M ² /hr	2Pass
	360X 600 DPI	50 M ² /hr	3Pass
	360 X 800 DPI	43 M ² /hr	4 Pass
	720 X 800 DPI	25 M ² /hr	6 Pass
	Print Direction	Uni and Bi-direction, selectable	
Media	Max Width	3400mm	
	Printing Width	Maximum 3200mm,	
	Type	Polyester	
	Width Adjustment	Manually adjustable, width test sensor	
	Transmission	Roll to Roll	
	Processing	Auto feeding and take-up system	
	Fabric Drive	High-precision motor controlled by servo	
	Fabric Tension	Media tension adjustable	
	Roller System	Rubber roller and stainless steel roller combination	
	Roll Weight	100-150kg maximum	
Ink Supply	Type	Water based dye sublimation ink, C, M, Y, K , LC, LM	
	Supply Mode	300ml per minute auto ink supply by electric pump	
	Volume	Main tank 4000ml per color	
	Negative Pressure	Negative pressure adjustable with a large capability pump for deferent environment	
	Inspection System	1. Auto/manual ink supply, low ink detector 2. Two level protection with two floaters	
System Features	Control Panel	1. 18 key control panel with LCD display for many hot key functions and self-diagnostic test	

		2. Cleaning control panel with one-key press to clean mono color print heads
	Servos	Three servos in the electric tank control: 1. Motion and location of print head 2. Feeding and location of media 3. Tension of media
	Fabric Dry System	Blower/ Infrared Heating System
	Print Head Cleaning System	1. Anti-clogged flashing system 2. Auto flush solution cleaning system with 3-way valve between ink and flush solution 3. Three levels for mono color cleaning optional for different situations: high, middle and low 4. Positive pressure adjustable from air pump
	Fabric feeding and Take-up System	1. Independent and automatic media feeding 2. Take-up system to hold heavy fabric rolls
	Noise Level	Printing status ≤ 70 dB, Waiting status ≤ 40 dB
	System Safety	1. Safety lock inside with auto shutting down 2. Emergency Stop button
System Certification		CE Mark
Work station	System Configuration	1. 2.8GHz CPU 2. 15" LCD display 3. 2G MB DDR memory 4. 160GB HDD
	Interface	USB 2.0 high speed interface
	Operating System	Windows XP, Windows 2000
	Printing Driver	Aprint RIP; and Onyx, Scanvec, Wasatch RIP supported
Power Supply	Input Voltage	AC 380V/400V ± 10 V, 50Hz/60Hz ± 1 Hz
	Electrical Consumption	8000VA
	Compress Air	0.7MPa, 0.3M ³ /Min
Work Environment	Temperature /Humidity	20°C - 28°C/40% - 70%RH
Dimensions	Without Packaging	5350mm (L) x 1370mm (W) x 1750mm (H)
	Assembling Space Size	8500mm (L) x 3000mm (W) x 2500mm (H)
Weight	Without Packaging	2000kg